



PROLOGIS PARK NORTH

BUILDING 16 • 3837 BAY LAKE TRAIL, NORTH LAS VEGAS, NV 89030

**COLLIERS
INTERNATIONAL**



FOR LEASE

- Building Size: ±513,240 SF
- ±283,920 SF Available
- Divisible from ±65,000 SF
- 32' Clear Height
- Dock and Grade Level Loading
- 35,000 lbs. Pit Levelers
- M-2 Zoning
- High Efficiency T-5 Fluorescent Warehouse Lighting
- White R-19 Insulated Ceilings
- 277/480 Volt, 3-Phase Power Available
- ESFR Fire Sprinklers
- Fairborn Dock Seals at every door
- Insulated Roll Up Doors
- Steel Bollards at every door
- 60' Concrete Truck Aprons
- Trailer Parking
- 190' Truck Court
- 1.25% Vented Skylights
- 50' x 50' Column Spacing Typical - 60' at First Column
- **Ready For Tenant Improvements**



ProLogis Park North is equidistant between the Cheyenne Ave. and Craig Rd. I-15 interchanges. Building 16 is a concrete tilt-up building divisible to units of approximately 65,000 square feet. Additional buildings are planned and build-to-suit opportunities are available within the park.



For more information please contact:

Dan Doherty, SIOR • Suzette LaGrange • Patti Dillon
ddoherty@lvcolliers.com • slagrange@lvcolliers.com • pdillon@lvcolliers.com

3960 Howard Hughes Pkwy., Suite 150
Las Vegas, Nevada USA 89109
Tel 702-735-5700 Fax 702-731-5709

An Independent Member of Colliers International
with Commercial Real Estate Offices throughout the
Americas, Europe, Middle East, Asia Pacific and Africa

702-735-5700
www.lvcolliers.com

The information furnished has been obtained from sources we deem reliable and is submitted subject to errors, omissions and changes. Although Colliers Nevada, LLC has no reason to doubt its accuracy, we do not guarantee it. All information should be verified by the recipient prior to lease, purchase, exchange or execution of legal documents.

PROLOGIS PARK NORTH

BUILDING 16 • 3837 BAY LAKE TRAIL, NORTH LAS VEGAS, NV 89030

**COLLIERS
INTERNATIONAL**



Southern Nevada Chapter

NAIOP SOUTHERN NEVADA

2006 MASTER PLANNED INDUSTRIAL PARK OF THE YEAR

Site Plan

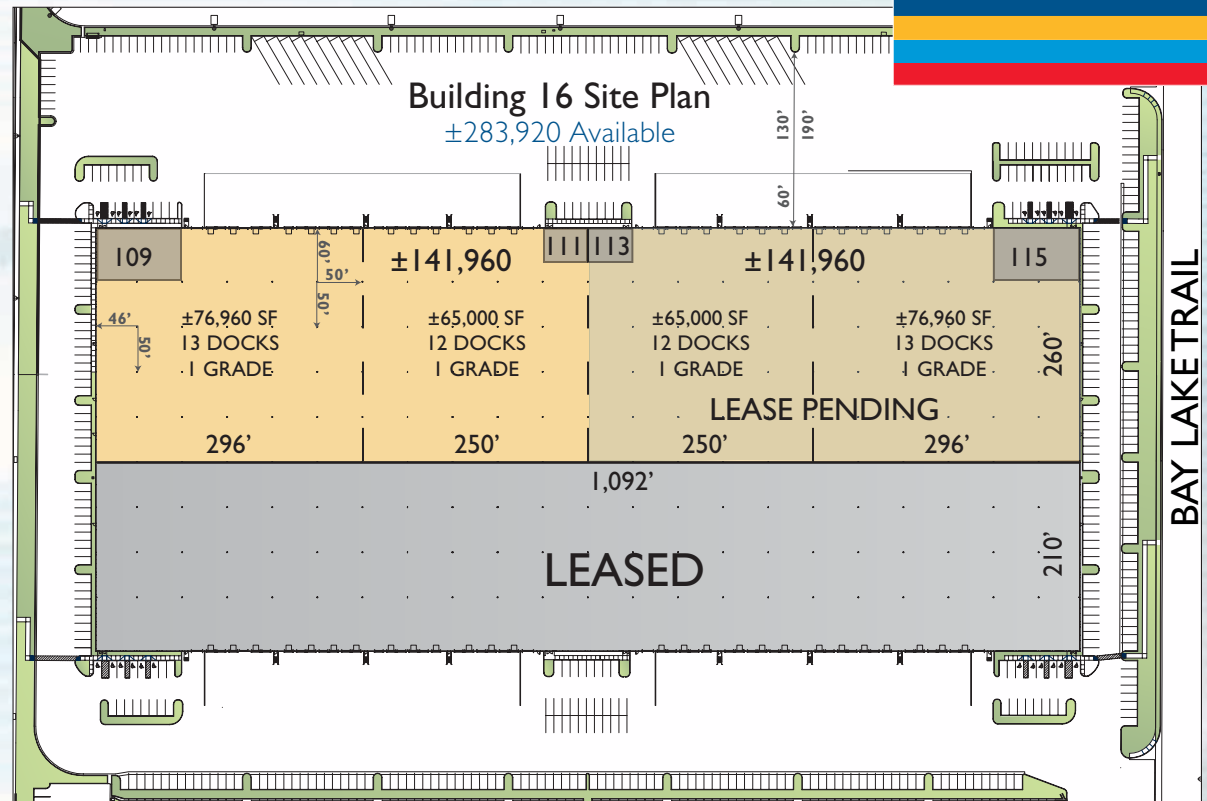
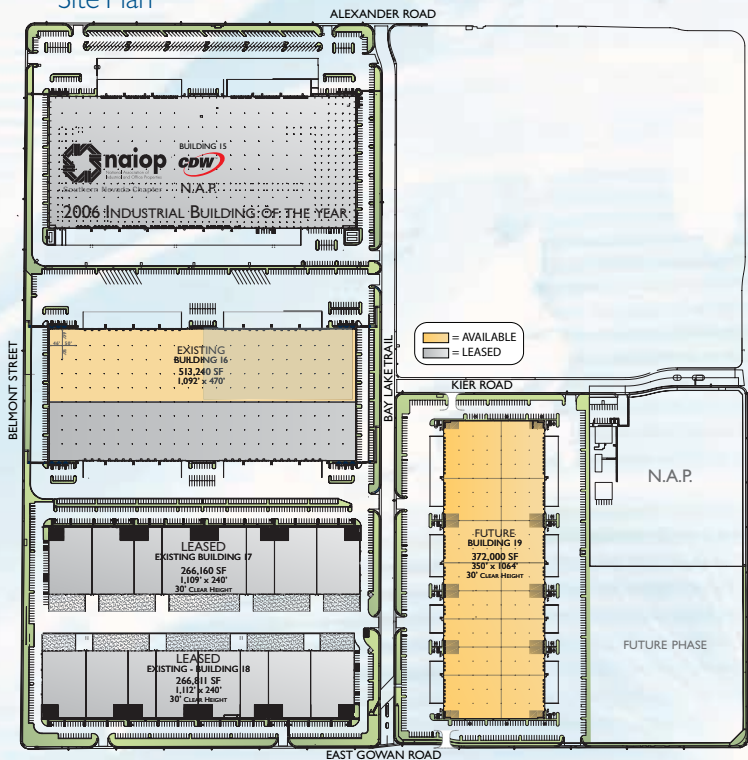

For more information please contact:

Dan Doherty, SIOR • Suzette LaGrange • Patti Dillon
 ddoherty@lvcolliers.com • slagrange@lvcolliers.com • pdillon@lvcolliers.com

3960 Howard Hughes Pkwy., Suite 150
 Las Vegas, Nevada USA 89169
 Tel 702-735-5700 Fax 702-731-5709

An Independent Member of Colliers International
 with Commercial Real Estate Offices throughout the
 Americas, Europe, Middle East, Asia Pacific and Africa

702-735-5700
 www.lvcolliers.com



The information furnished has been obtained from sources we deem reliable and is submitted subject to errors, omissions and changes. Although Colliers Nevada, LLC has no reason to doubt its accuracy, we do not guarantee it. All information should be verified by the recipient prior to lease, purchase, exchange or execution of legal documents.

BAY LAKE TRAIL