

DEVELOPMENT OPPORTUNITY FULLY ENTITLED RETAIL CENTER

Corner of Vasco & Brisa Dr., Livermore, CA
A Planned 33,900 SF Project

FOR LEASE

PARCEL SIZE - 3.616 ACRES



- Located in one of the Fastest Growing Areas of the Tri-Valley
- Near Ace Train station
- Existing High Income Residential Neighborhoods nearby.
- * An additional 510 Residential Units Planned Directly Across The Street
- Easy Freeway Access from I-580 at Vasco Road

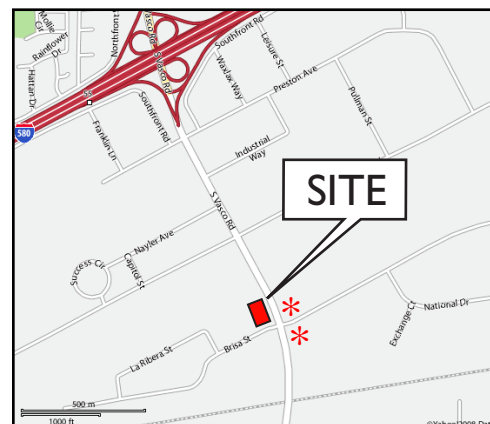

Features:

- Anchor Tenant Space, Shop Spaces and a Restaurant Pad
- Monument Signage
- Traffic Counts: 35,000 Average Daily Car Count
- Two Parcels: A-1.616 Acres
B-2.010 Acres



FOR LEASE

COLLIERS
INTERNATIONAL

Sandra Weck
925-227-6230
sweck@colliersparish.com
CA License No. 00861536

Mike Copeland
925-621-3855
mcpeland@ctbt.com
CA License No. 00898210

Mark Triska, SIOR
925-227-6210
mtriska@colliersparish.com
CA License No. 01012779

COMMERCIAL RETAIL REAL ESTATE SERVICES | INVESTMENTS | PROPERTY MANAGEMENT

Information contained herein has been obtained from the owners or other sources deemed reliable. We have no reason to doubt its accuracy but we cannot guarantee it. All properties subject to change or withdrawal without notice.

DEVELOPMENT OPPORTUNITY FULLY ENTITLED RETAIL CENTER

Corner of Vasco & Brisa Dr., Livermore, CA
A Planned 33,900 SF Project



FOR LEASE

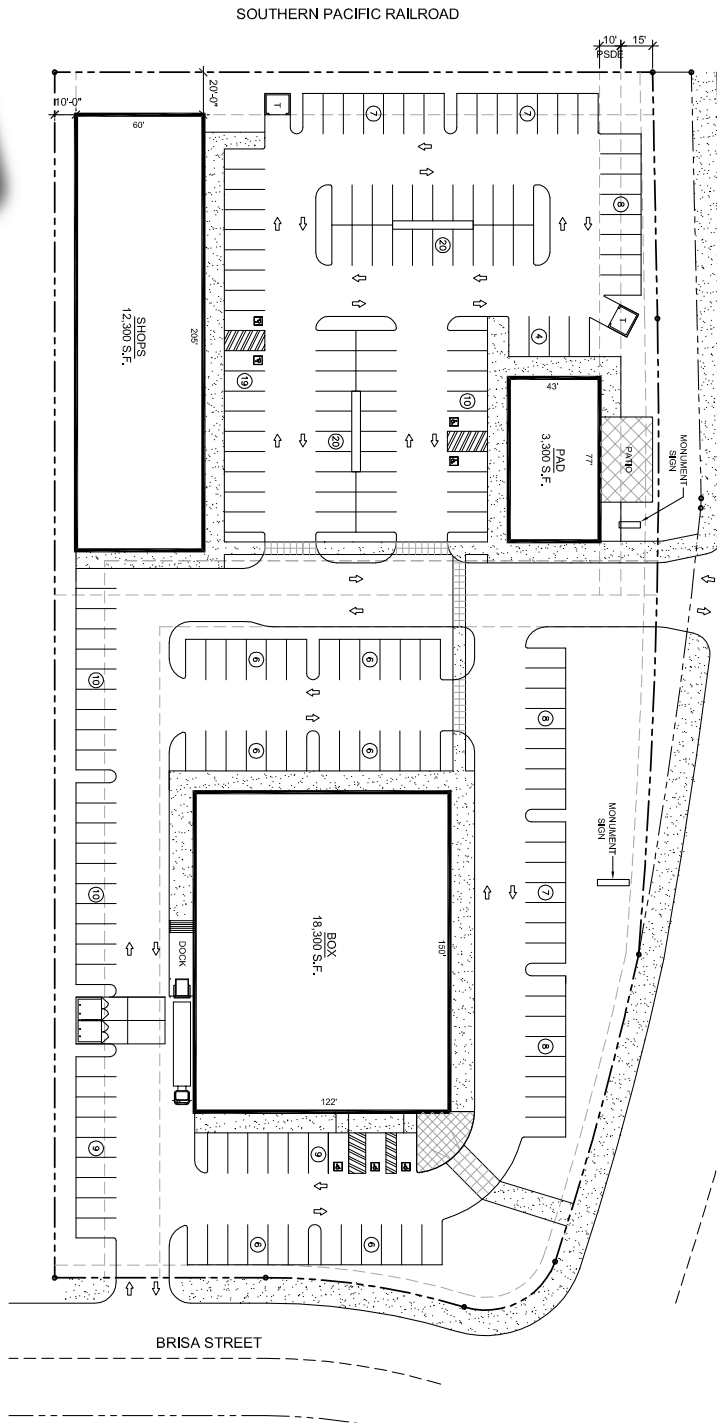

Demographics:

	3 Mile	5 Mile
Population	23,548	47,963
Daytime Pop	40,595	78,668
Ave HH Inc.	\$106,114	\$103,545

COLLIERS
INTERNATIONAL

Sandra Weck
925-227-6230
sweck@colliersparish.com
CA License No. 00861536

Mike Copeland
925-621-3855
mcpeland@ctbt.com
CA License No. 00898210

Mark Triska, SIOR
925-227-6210
mtriska@colliersparish.com
CA License No. 01012779

COMMERCIAL RETAIL REAL ESTATE SERVICES | INVESTMENTS | PROPERTY MANAGEMENT

Information contained herein has been obtained from the owners or other sources deemed reliable. We have no reason to doubt its accuracy but we cannot guarantee it. All properties subject to change or withdrawal without notice.