

UP TO ±506,490 SQUARE FEET AVAILABLE



901 PAGE AVENUE, FREMONT, CA MANUFACTURING/WAREHOUSE/DISTRIBUTION FACILITY

**Largest Available Manufacturing/
Warehouse/Distribution Building in the
SF Bay Area**

**Ideal for Clean Technology Companies,
Heavy Power Users or
Regional Warehouse/Distribution Facility**

**Current HP Facility – State of the Art
Manufacturing Improvements**



BUILDING INFORMATION:

Size

- ±506,490 SF situated on 29.89 acres of land
- ±324,800 SF of manufacturing/warehouse/distribution space
- ±181,690 SF of office space, lab and cafeteria (Ground Floor & Mezzanine)
- Divisible to ±200,000 SF
- Expansion: Up to ±160,000 SF in Phase II

Property Highlights

- ±25' – ±37' clear height
- Typical column spacing 40' X 40'
- Power: 10 MVA load capacity (12,000 Amps @ 277/480 Volts)
- 100% HVAC – Greater than 1,500 tons
- ESFR sprinkler system servicing the warehouse area
- Manufacturing areas have epoxy-coated ESD concrete slab floor
- ±10,000 gallon nitrogen tank

Amenities

- Fitness center with separate men's and women's restroom, shower, and locker facilities
- Full service commercial kitchen, cafeteria, and outdoor seating area

Location

- Excellent I-880 & I-680 access – easy Highway 237 access
- Centrally located within 25 miles of the Port of Oakland, Oakland Int'l, San Francisco Int'l & San Jose Int'l Airports

FIRST FLOOR PLAN

Warehouse – Area A	Warehouse – Area B
Size: ±102,400 SF	Size: ±102,400 SF

Warehouse Areas:

- 35' - 37' clear height
- Dedicated HVAC provided by one chiller (300-ton) and seven roof mounted air handlers
- Five 20-ton package units

Manufacturing

Size: ±120,000 SF

- Dedicated HVAC provided by three chillers (125-ton and two 200-ton) and six roof mounted air handlers
- Two 50-ton boxcar package units provide back-up cooling
- Epoxy-coated ESD flooring
- Overhead power distribution bars
- 25' - 27' clear height

Office/Lab/Amenities

Size: ±91,485 SF

- Open office environment
- Lab areas
- Cafeteria/full kitchen
- Fitness Center (no equipment)

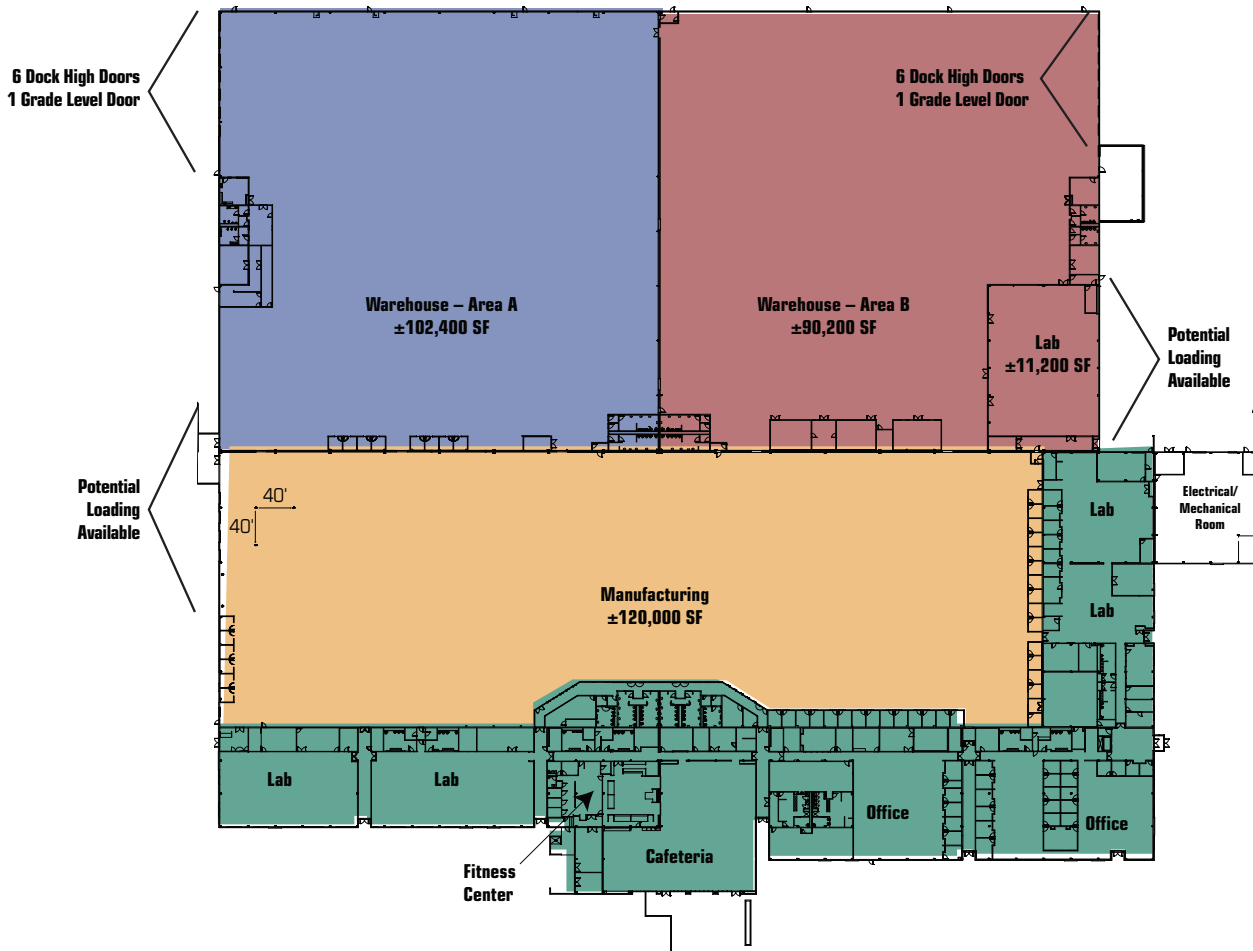

Not to scale

SECOND FLOOR PLAN

Second Floor/Mezzanine

Size: ±90,205 SF
 Open office environment

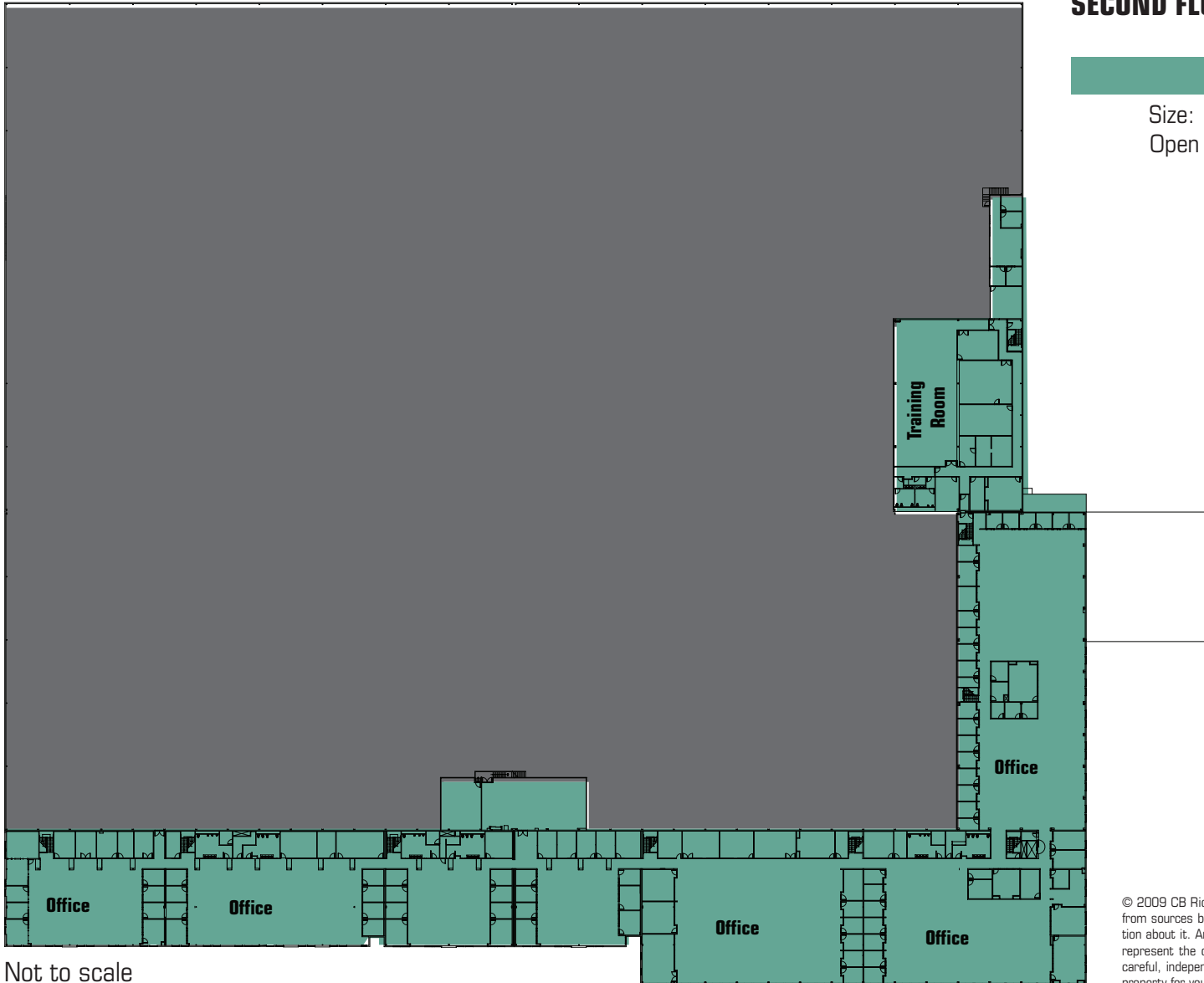

Not to scale

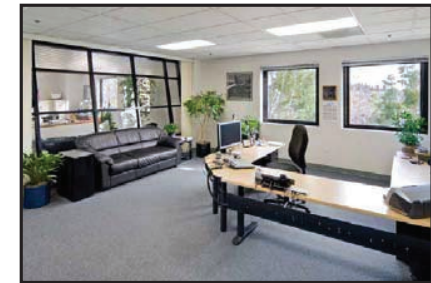

© 2009 CB Richard Ellis, Inc. and Colliers Parrish International, Inc. This information has been obtained from sources believed reliable. We have not verified it and make no guarantee, warranty or representation about it. Any projections, opinions, assumptions or estimates used are for example only and do not represent the current or future performance of the property. You and your advisors should conduct a careful, independent investigation of the property to determine to your satisfaction the suitability of the property for your needs.

SITE PLAN

PROJECT DATA

Site Area: 1,302,149 SF
29.9 Acres

Building Area:

Tenant 1:
First Floor
Warehouse: 112,737 SF
Office: 95,290 SF
Second Floor
Office: 76,270 SF

Total: 284,747 SF

Tenant 2:
First Floor
Warehouse: 101,345 SF
Office: 2,500 SF
Second Floor: 12,329 SF

Total: 116,174 SF

Tenant 3:
First Floor
Warehouse: 101,345 SF
Office: 2,500 SF
Second Floor: 1,724 SF

Total: 105,589 SF

Total Building Area: 506.490 SF

F. A. R.: 37.8%



- GRADE LEVEL DOOR
- ▲ DOCK HIGH DOOR
- ▼ FUTURE DOCK HIGH POSITION

Loading

- Abundant dock high & grade level loading (potentially up to 60 dock high doors)

Parking

- 2.41/1,000 SF (1,220 auto parking spaces)

Not to scale



Page Technology Park

901 PAGE AVENUE, FREMONT, CA

For more information, contact:

Rob Shannon, SIOR, CCIM

Lic. 00857593
CB Richard Ellis
408.453.7486
rob.shannon@cbre.com

Greig Lagomarsino, SIOR

Lic. 01063817
Colliers International
510.433.5809
glago@colliersparrish.com

Joe Kelly

Lic. 01420963
CB Richard Ellis
408.453.7474
joe.kelly@cbre.com

Ben Knight

01850353
CB Richard Ellis
408.453.7441
ben.knight@cbre.com

www.pagetechnologypark.com

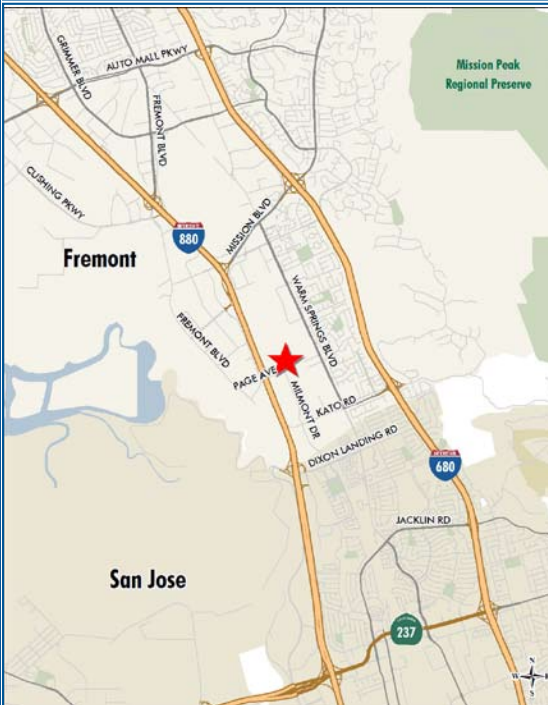
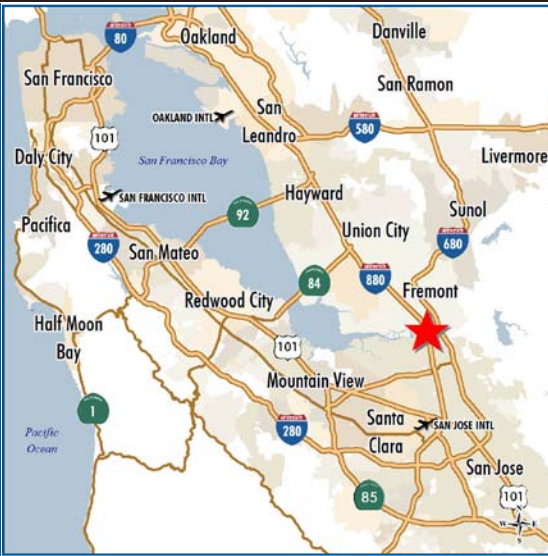

CB Richard Ellis, Inc.
Broker Lic. 00409987

**Owned and
Managed By:**



Colliers Parrish International, Inc.
Broker Lic. 00490878

