

FOR LEASE OR SALE

R&D MANUFACTURING | ±61,940 SF



2150 COMMERCE DRIVE, SAN JOSE

- ±15,000 SF Office Area
- 3,000 Amps, 277/480 Volts, 3 Phase Power
- 10 Mega Watts of Power On Site
- 3.9/1,000 Parking Ratio
- 100% HVAC
- Shower
- 2 Dock High Doors, 3 Grade Level Doors

- Kaeser CompAir Compressor, Model TE 121
- 16' Clear Height
- 10' Ceilings in Office Area
- Back Up Generator
- Sentrilock Lockbox on Double Doors to Left of the Entry Door

BUILDING IS ALARMED. CALL FOR CODE

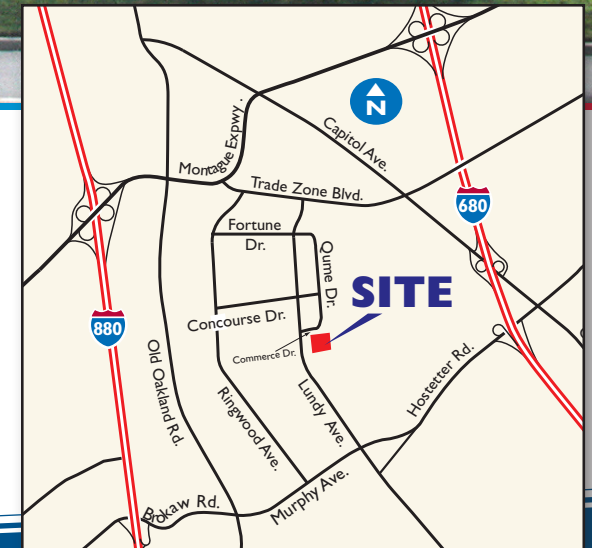

Exclusive Agents:

COLLIERS
INTERNATIONAL

CRAIG FORDYCE, SIOR, CCIM
(408) 282-3911
cfordyce@colliersparrish.com
CA License No. 00872812

BING HECKMAN
(408) 282-3805
bheckman@colliersparrish.com
CA License No. 00837083

COLLIERS INTERNATIONAL | WWW.COLLIERSPARRISH.COM
450 WEST SANTA CLARA STREET, SAN JOSE, CA 95113 | 408.282.3800 | 408.292.8100 FAX

The information furnished has been obtained from sources we deem reliable and is submitted subject to errors, omissions and changes. Although Colliers International has no reason to doubt its accuracy, we do not guarantee it. All information should be verified by the recipient prior to lease, purchase, exchange, or execution of legal documents. © 2010 Colliers International

2150 COMMERCE DRIVE, SAN JOSE

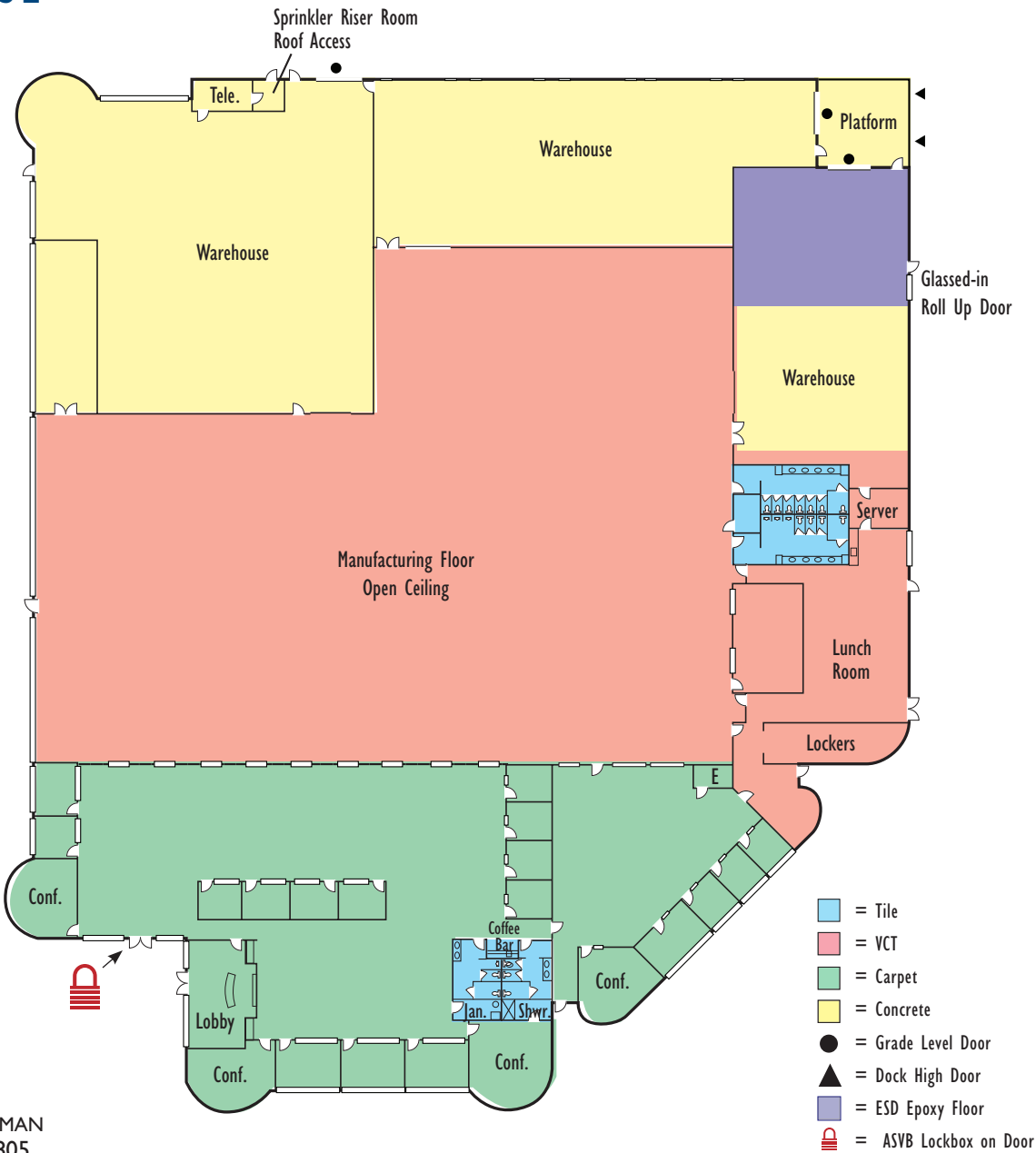
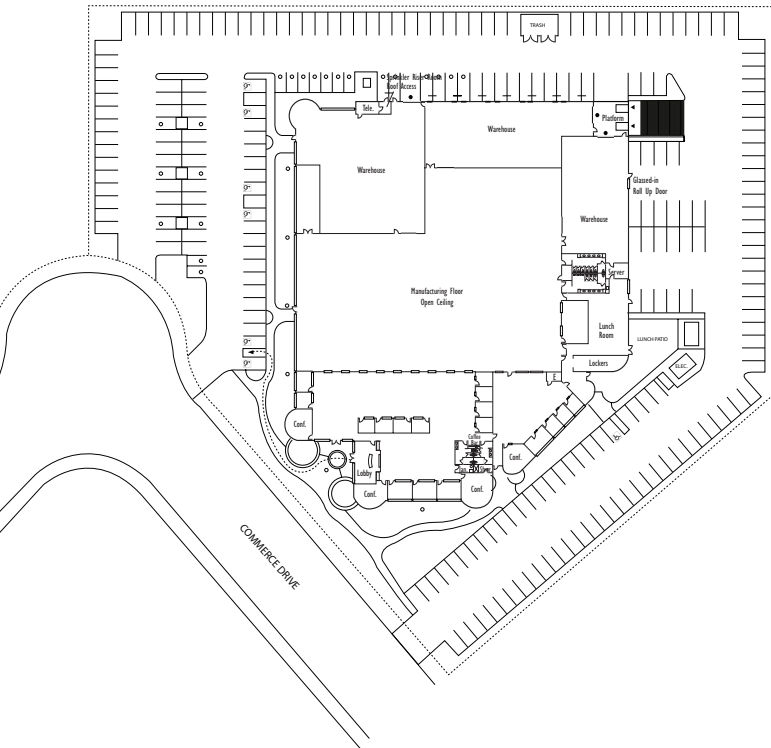

Exclusive Agents:

CRAIG FORDYCE, SIOR, CCIM
 (408) 282-3911
 cfordyce@colliersparrish.com
 CA License No. 00872812

BING HECKMAN
 (408) 282-3805
 bheckman@colliersparrish.com
 CA License No. 00837083

Drawings Not Exact/Not to Scale

COLLIERS INTERNATIONAL | WWW.COLLIERSPARRISH.COM

450 WEST SANTA CLARA STREET, SAN JOSE, CA 95113 | 408.282.3800 | 408.292.8100 FAX

The information furnished has been obtained from sources we deem reliable and is submitted subject to errors, omissions and changes. Although Colliers International has no reason to doubt its accuracy, we do not guarantee it. All information should be verified by the recipient prior to lease, purchase, exchange, or execution of legal documents. © 2010 Colliers International